



# HITACHI

Inspire the Next

## Instruction Manual

### Hitachi Air Purifier

Model

# EP-PF120J

# EP-PF90J

Thank you for purchasing a Hitachi air purifier.  
This air purifier is for household use only.  
Do not use it for any other purpose besides purifying air.  
**Please read this instruction manual carefully before using this product to ensure the unit is operated correctly.**  
For future reference, keep this manual in an easily accessible place.

Read "Safety Precautions" → **(P.E-8 - E-12)**  
to ensure correct use.

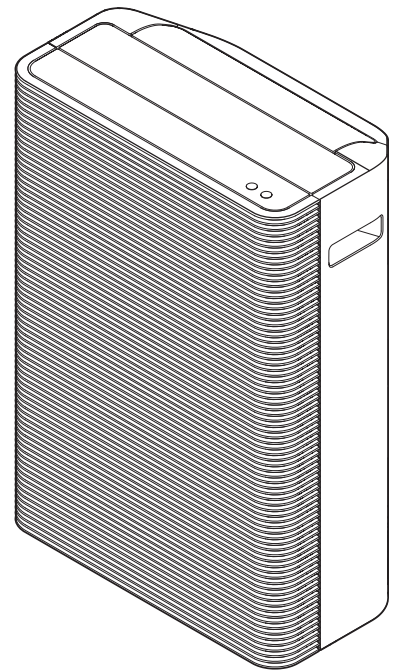



# Contents

## Before Use

Name of Each Component / Accessories .....	E-4
Operating the Touch Operation Panel .....	E-6
Safety Precautions .....	E-8
Cautions on Use .....	E-13
Preparations for Operation .....	E-14
Setting Filter in Unit .....	E-14
Installation .....	E-16

## Operating Air Purifier

Operation .....	E-17
Starting Operation .....	E-17
Switching Airflow Rate .....	E-17
Switching Touch Operation Panel Display .....	E-18
Useful Features .....	E-19
Selecting a Mode .....	E-19
Switching Between PM2.5/Odor&TVOC/ Timer Monitor Display .....	E-20
Stopping Operation Using Off-timer .....	E-20
Setting the Child Lock .....	E-21
Making the Flap Swing .....	E-21
Displaying the estimated cleaning and replacement periods of each filter .....	E-22
If a filter indicator blinks .....	E-23
Resetting a filter indicator .....	E-23
Memory Function / Monitor / Sensors / Auto Detection .....	E-24
Memory Function .....	E-24
Clean Monitor .....	E-24
Odor Sensor .....	E-24
Dust Sensor .....	E-24
Auto Detection .....	E-24
Light Sensor .....	E-25
Adjusting Sensory Sensitivity Setting .....	E-25

## Cleaning and Maintenance

Cleaning .....	E-26
Pre-filter .....	E-26
Dust Filter / Deodorizing Filter .....	E-27
Purifier .....	E-28
Dust Sensor .....	E-28
Replacing the Dust Filter / Deodorizing Filter .....	E-29
Replacement Interval .....	E-29
How to Replace the Dust Filter / Deodorizing Filter .....	E-30
Troubleshooting Guide .....	E-31
Replacement Parts .....	E-34
Specifications .....	E-35

# Name of Each Component / Accessories

## Names of Each Component



### CAUTION

- Do not hold the flaps when moving the unit. Doing so may cause unexpected injury when the unit is damaged and overturned or dropped.

Air outlet  
(stainless steel net)

Flap

Power button

Purifier

Front panel  
(Air inlet)

Clean monitor → (P.E-24)

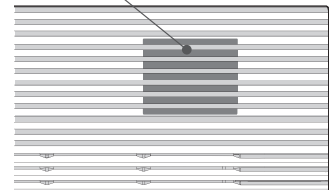

Handle

Power plug

Power cord

### Caster

To prevent fall over, movement is only in sideways direction. (Located at the base of the unit)



■ → (P.E-○○) Numbers are pages containing the main description each parts.

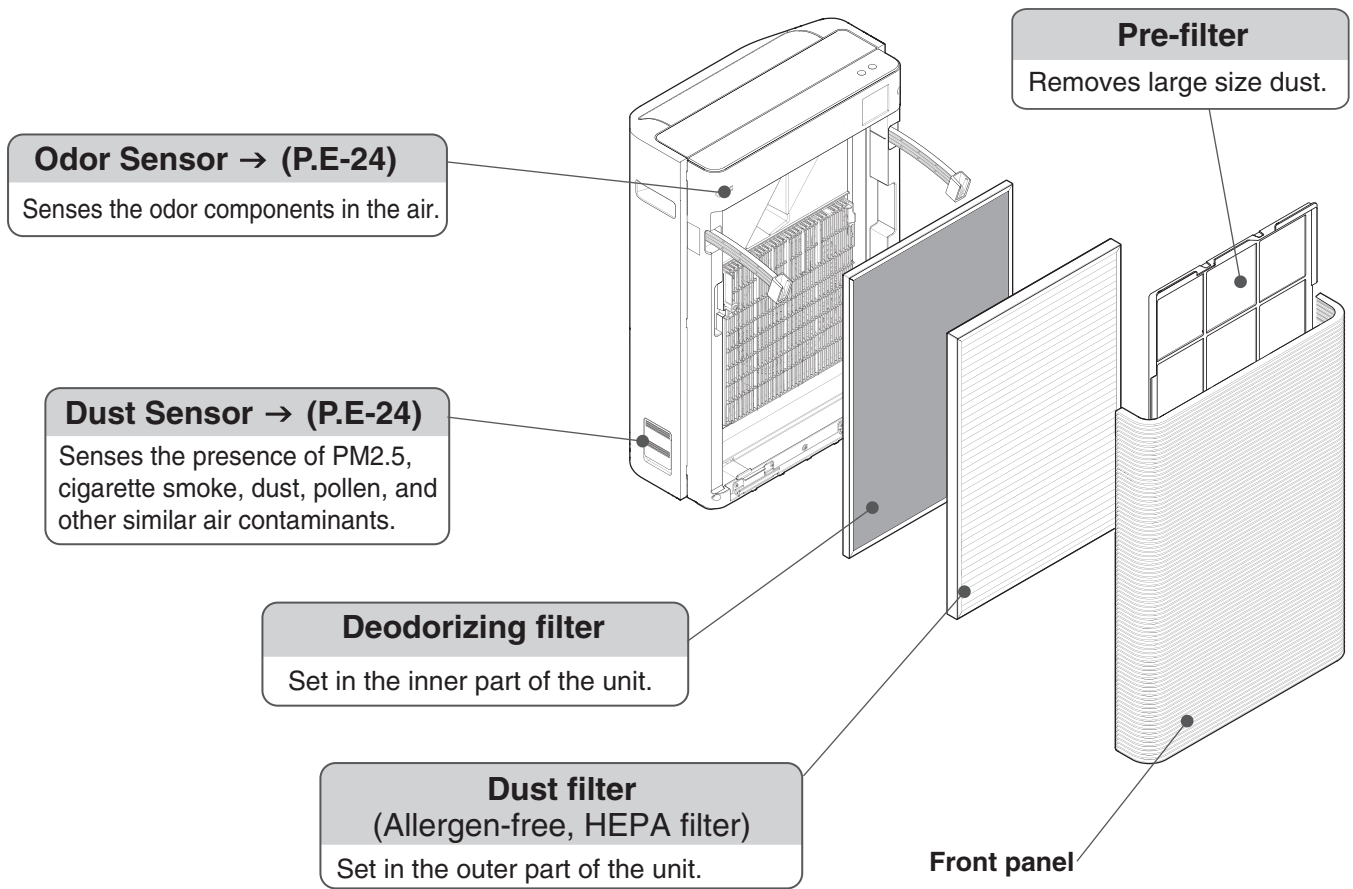

## Accessories

### Filters

Housed inside the purifier.

\* The filters must be removed from the plastic packaging before operating the unit.

### CAUTION

The vibration during transporting the unit might cause deodorizing agent granules to fall out from the filter.

- When removing the plastic packaging of the filters and attaching the filters to the unit, make sure that your hands, clothes, and the surroundings will not get dirty.
- Wipe of any granules that may have fallen or clung to the filters.
- This will not affect the deodorizing performance.

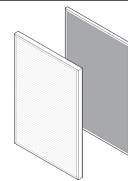

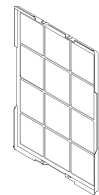

Dust Filter (×1)  
Deodorizing Filter (×1)

### Pre-filter



(×1)

# Operating the Touch Operation Panel

- If the touch operation panel display is off, touch  to display it again.  
The touch operation panel display will be off when  is touched again.
- The monitor display changes to the PM2.5 indicator when the menu button is touched regardless of the current display.
- Use the touch operation panel to switch settings.

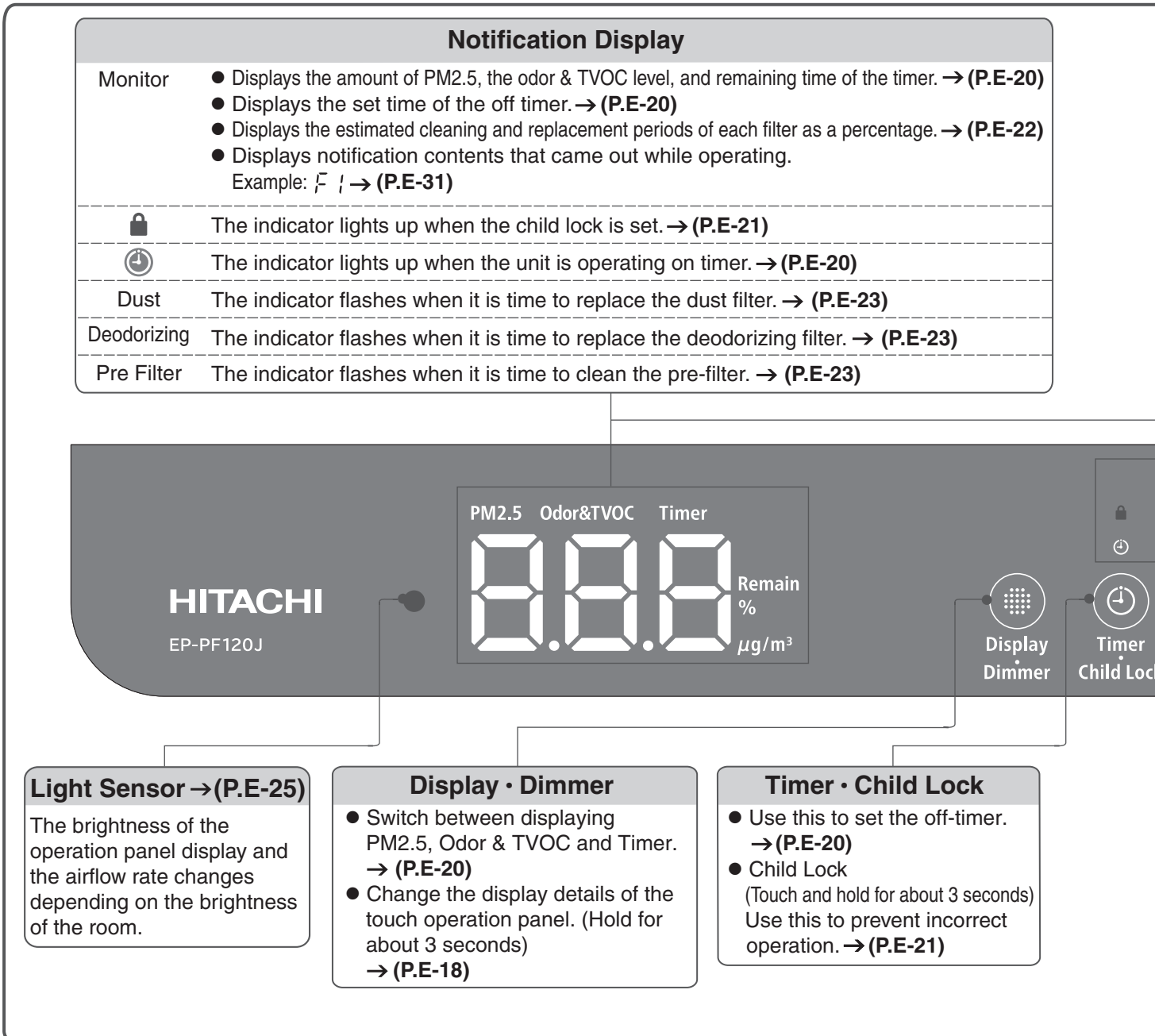

## Note

- Buttons do not respond at the moment they are touched.  
They respond after you touch them and release your finger.
- Button operation may have a different reaction depending on the surrounding temperature and humidity, physical condition of the user (such as body temperature and sweat), and the condition of the electronic appliances near by the unit.
- If a button does not respond, touch it again and release your finger.  
If the interval between touches is short, the unit may respond incorrectly.  
The sensitivity will not change by the force applied when touching.
- There may be no response if the operation panel is wet or dirty.  
Wipe off with a dry cloth to use.
- The operation panel display may be difficult to view if the unit is placed in brightly lit places such as near a window with direct sun light.

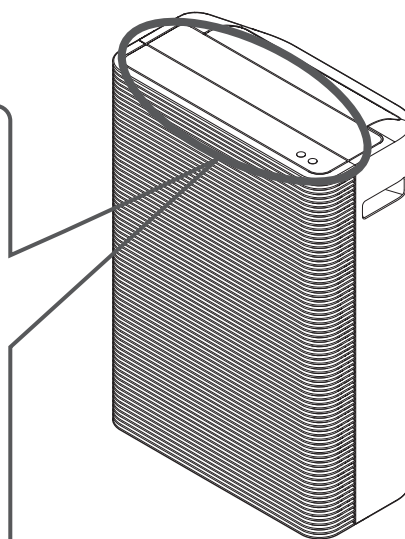
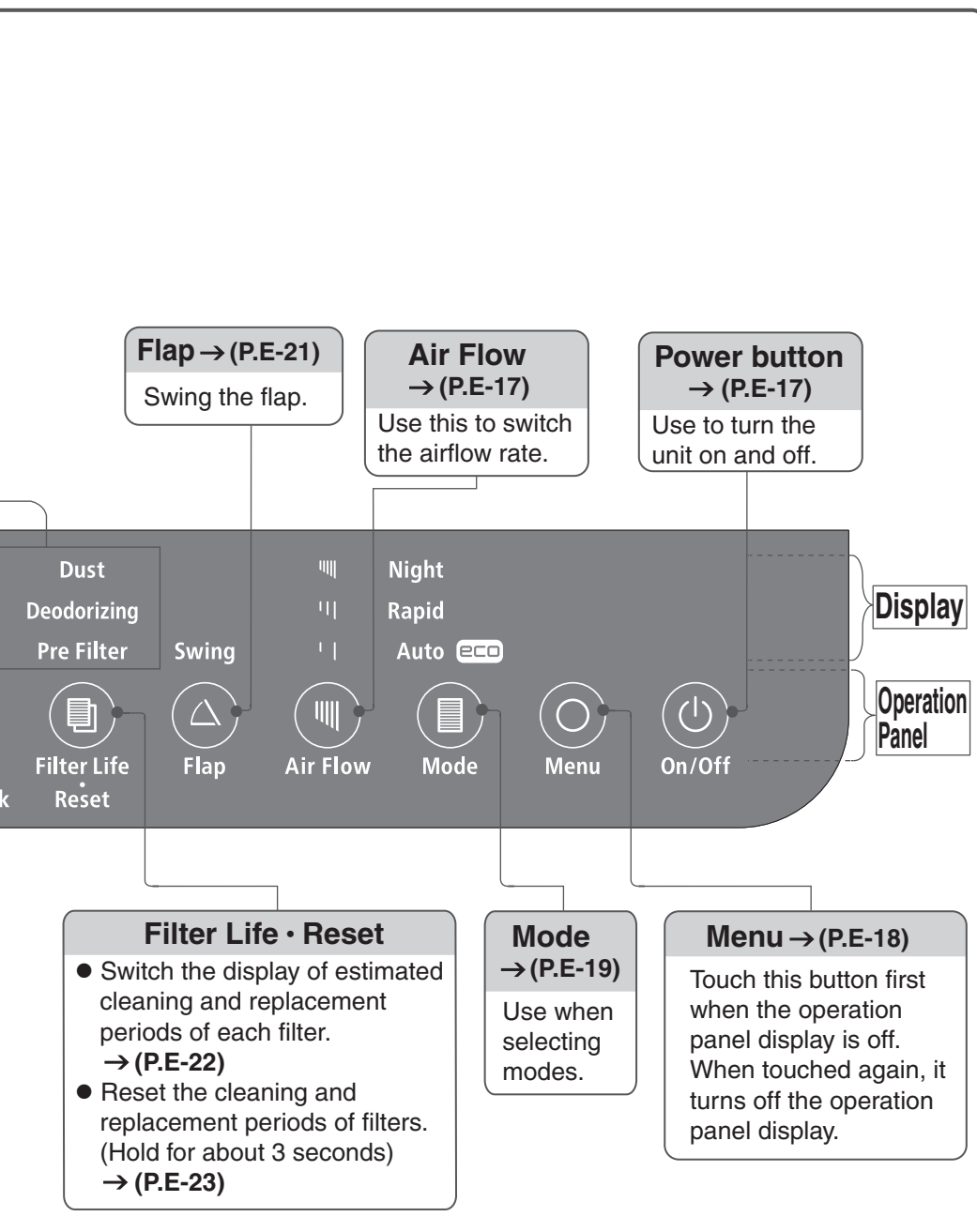



# Safety Precautions



- **Please read the following safety precautions carefully before using the unit.**

To prevent injury to the user or other people and property damage, the following instructions must be followed. Also read the precautions appearing in the text carefully to ensure correct use.

- **Definition of each indication**

Incorrect operations that are carried out as a result of ignoring instructions will cause harm or damage. The seriousness is classified by the following indications.

 <b>WARNING</b>	This symbol indicates the possibility of death or serious injury.
 <b>CAUTION</b>	This symbol indicates the possibility of injury or damage to property.

Meaning of Symbols	
	Indicates "warning or caution".
	Indicates "prohibition".
	Indicates "necessity".

## **WARNING**

### To Prevent Fire, Electric Shock and Injury

#### AC Outlet, Power Plug and Power Cord



- **Remove dust from the blade and the blade mounting surface of the power plug.**  
Otherwise, it may cause a fire.
- **Be sure to unplug the power cord from the AC outlet when cleaning or not using the unit for an extended period of time.**  
Otherwise, it may cause an electric shock or injury.
- **Be sure to hold the plug when unplugging it.**  
Otherwise, it may cause an electric shock or short-circuit, which may result in a fire.
- **Securely insert the power plug into the AC outlet.**  
Otherwise, it may cause an electric shock, overheating or fire.



- **Do not stop operation by unplugging the power plug.**  
Otherwise, it may cause fire, electric shock or malfunction.
- **Never plug or unplug the power plug with wet hands.**  
Otherwise, it may cause an electric shock.
- **Do not use a damaged power cord or power plug, or a loose AC outlet.**  
Otherwise, it may cause an electric shock, short-circuit or ignition.
- **Do not damage the power cord.**  
(Do not break, modify, forcibly bend, pull or twist it. Also do not place any heavy objects on it, pinch it, or step on it when moving it with the caster.)  
Otherwise, it may cause damage to the power cord, fire or ignition.
- **Make sure to avoid inserting too many plugs into the AC outlet.**  
Otherwise, it may cause fire or ignition.
- **Do not immerse the power plug in water, or pour water on it.**  
Do not use a power plug when wet.  
Doing so may cause ground leakage, electrical shock and unit failure.
- **If the supply cord is damaged, it must be replaced by the manufacturer, its service agent or similarly qualified persons in order to avoid a hazard.**
- **Do not use with a voltage other than 220-240V AC.**  
Otherwise, it may cause a fire or electric shock.

# WARNING

## Before Use

---



- **Ventilate the room frequently when in use with heating appliances.**

Otherwise, it may cause carbon monoxide poisoning.  
This product cannot remove carbon monoxide.



- **Do not block the air outlet or air inlets with laundry, cloth, curtains, etc.**

Poor ventilation may cause overheating or fire.

- **Do not use flammable materials (hair sprays, insecticides, air fresheners, etc.) near the unit.**

Do not use benzene, thinner or alcohol to clean the purifier.  
Otherwise, it may lead to cracking, electric shock, ignition, smoke or fire.

- **Do not use in a kitchen as a substitute for a ventilation fan and range hood fan.**

Otherwise, it may cause unit deformation by heat or it may ignite a fire in the filter.  
Also, it may cause failure or a decrease in the lifespan of the pre-filter, dust filter and deodorizing filter.

- **Keep away from lit candles, mosquito coils, lit cigarettes, etc. Also, do not let smoke from these materials enter the unit.**

Otherwise, it may cause fire.

- **Do not operate the unit when using fumigating (smoking) type insecticide. Do not let chemicals enter the unit.**

Use of such insecticides will cause chemicals to accumulate in the unit and depending on a person's sensitivity to these chemicals, it may be harmful to one's health.

- **Do not place in a location where the air from the outlets will blow directly onto heating appliances.**

Otherwise, it may cause incomplete combustion and carbon monoxide poisoning.

- **Do not use in narrow spaces such as gaps between the furniture or closet.**

Poor ventilation may cause overheating or fire.

- **Do not operate the unit while filter, etc. is detached.**

Otherwise it may cause injury or failure.

- **Do not tilt or tip the unit over. Do not put your weight on the unit or step on it. Also, do not use it in an unstable place or anywhere near infants.**

Otherwise, it may cause the unit to tip over due to vibration, which may cause an injury or unit failure.

## Cleaning

---



- **When cleaning, do not splash water on the unit.**

It may cause short-circuiting and electric shock.

- **Do not add water by submerging or splashing water on the unit.**

It may cause short-circuiting and electric shock.

# Safety Precautions (Continued)



## WARNING

### Cleaning

---



- **Do not use detergents when cleaning.**

Usage of chlorine-based and acid type detergents will generate toxic gas and can cause a health threat. Also, do not use neutral detergents as it may affect the plastic.

### Place of Use

---



- **Do not use in a location where there is huge amount of oily smoke such as in cafeterias and eateries.**

The oil residue or dust deposited in the unit may cause fire, unit failure and unpleasant odor.

- **Do not use in a location where there is flammable gas, corrosive gas or metallic dust, or risk of leakage of oil, flammable gas.**

It may cause fire, explosion or unit failure.

- **Do not use in a location where solvents such as paint and adhesives are being used or stored.**

It may cause deterioration of parts or fire.

- **Do not use in a location where soot from oil, such as machine oil, is floating in the air.**

It may cause a crack, electric shock or fire.

- **Do not use in a location where any chemical is used. (Hospitals, factories, laboratories, beauty salons, photographic laboratories, etc.)**

Chemicals and solvents evaporating into the air deteriorate the unit. This causes electric shock.

- **Do not use in a humid place or in a place where it may easily be wet, such as in a bathroom.**

It may cause electric shock or fire due to ground leakage.

- **Do not place it near a hot object such as a heater.**

It may cause deformation, discoloration, injury and unit failure.

- **Do not put in places exposed to direct sunlight, wind and rain.**

It may cause overheating, electric shock and fire due to ground leakage.

- **Do not use in a location where a machine tool that produces flammable dust or sparks (such as a grinder or welder) is installed.**

It may cause fire.

### Miscellaneous

---



- **Even after switching on, sometimes the air purifier is inoperative or air does not come out. There may be “cracks” and “scratches” in the power cord, or the unit has been moved which causes the operation to stop. There may also be unusual noise and vibration during operation. The unit may be deformed and unusually hot. There may be a burnt odor. If there are abnormalities aside from those mentioned, unplug the power cord immediately to prevent accidents and contact your dealer to request for checks or repairs.**

These may cause fire due to electric shock, ground leakage or short-circuiting.

- **Pay specific attention when the user of the air purifier is the following: (Infants, children, the elderly, those who cannot control their body temperature)**

When the body is exposed directly to the wind for a long time, health may be compromised.

## ! WARNING

### Miscellaneous



- **Do not put your finger or any other object (metal, paper, etc.) into the air inlet or outlet.**  
It may cause injury, electric shock and fire.
- **Never attempt to disassemble, modify or carry out repairs by yourself.**  
It may cause fire, electric shock or injury. (Contact your dealer for repairs)
- **Children should be supervised to ensure that they do not play with the appliance.**

## ! CAUTION

### Moving the Air Purifier



- **Move only in sideways direction with the caster (to prevent from falling).**  
There are cases when the floor may be damaged based on the type of flooring.  
Unplug the power cord from the AC outlet.
- **Lift the air purifier when moving it along a mat, a floor susceptible to scratches, an uneven floor or a thick carpet.**  
It may damage the mat, floor and carpet and may cause unit failure and injury when tipped over.
- **When carrying the air purifier, hold the handle firmly.**  
If you hold parts other than the handle, the unit may tip over and be damaged, and may cause an accident.
- **Unplug the power cord from the AC outlet.**  
When moving the unit without unplugging, the power plug and power cord may be damaged.



- **Do not touch, hold, or lift the moving flap.**  
It may cause an injury and unit failure.  
When carrying the air purifier, hold the handle.
- **Do not pull the power cord when moving the unit.**  
It may damage the power cord.

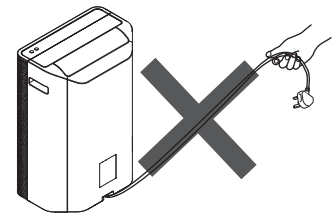

### Place of Use



- **Do not use the air purifier near a wall that cannot be scrubbed, such as a white cloth-covered wall.**  
The air purifier will take in the surrounding air and may stain a wall near its air outlet.
- **Do not use in storerooms for artworks and academic materials, or for other business purposes.**  
It may deteriorate the quality of the stored products.
- **Do not put water containers such as flower vases and fish bowls on top or near the unit.**  
Water deposited in the unit may cause electric shock, fire and unit failure.
- **Do not use in locations near cooking appliances.**  
It may cause deterioration of parts, electric shock and fire due to heat and oily smoke.
- **Do not use on floors susceptible to scratches such as Cypress floors.**  
It may damage the floor.



# Safety Precautions (Continued)

## CAUTION

### Cleaning

---



- **Perform front panel removal and installation carefully.**  
It may cause injuries such as pinching your fingers.
- **When cleaning, lay a soft cloth on the floor and place the unit and detached parts (front panel, etc.) on it**  
Otherwise, it may scratch the floor.
- **Attach the parts securely after cleaning**  
Do not use with the front panel, pre-filter, dust filter, deodorizing filter, and any other parts detached. Otherwise, it may cause unit failure.

### Miscellaneous

---



- **Do not move or stop the flap by hand or by any object**  
Otherwise, it may cause unit failure.
- **If using the purifier around pets, do not subject any parts to urine and keep pets away from the power cord**  
Otherwise it can cause electric shock and fire. If there are damages, unplug and request repairs.



- **Use only a genuine filter for the Hitachi Air Purifier**  
Other filters may cause unit failure.
- **This appliance is not intended for use by persons (including children) with reduced physical, sensory or mental capabilities, or lack of experience and knowledge, unless they have been given supervision or instruction concerning use of appliance by a person responsible for their safety.**



# Cautions on Use

## Do not operate with the filter detached

Otherwise, no cleaning effect can be expected. It may also cause unit failure.

## Do not block or touch the odor and dust sensors

It may reduce the sensitivity of the sensors.

## Do not use in locations near cooking appliances

It may cause deformation and discoloration due to heat or oily smoke, unit damage or fire.

Place the purifier and the cooking appliance at least 1m apart from each other.

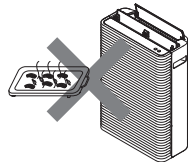

## Ventilate closed rooms occasionally

The purifier does not have a ventilation effect (removal of carbon monoxide and other contaminants).

\* The purifier cannot remove harmful substances in cigarettes (carbon monoxide, etc.).

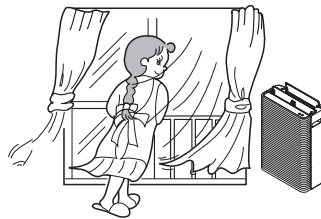

## Do not directly fan plants and animals

It may adversely affect them.

## Refrain from placing any object on the unit and blocking the air inlet and outlet

Doing so may cause unit failure and injury.

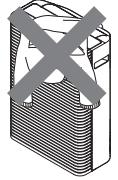

## Refrain from moving (changing the orientation or lifting the unit, etc.) during operation

Moving the unit while in operation may cause the fan to hit the inner case, generate noise, pull and disconnect the power cord, and cause unit failure.

## Do not use near television or radio

Doing so may interfere with broadcasts.

Place them at least 2m apart from each other.

The same applies for cordless phones and wireless microphones.

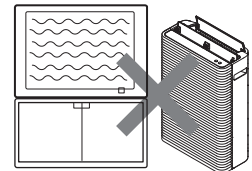

# Preparations for Operation

## CAUTION

- Movement with casters should be done slowly. The movement is only in sideways direction. (To prevent from falling)
- No cleaning effect will be experienced if the filter is set without detaching the plastic packaging. It will also cause unit failure.
- Do not tip over or tilt the unit.

## Setting Filter in Unit

- Setting procedure is the same with filter replacement. (Use only genuine Hitachi Air Purifier filters.)

# 1

### Remove front panel and pre-filter

- ① Place the unit on a flat and stable location.
- ② While supporting the unit, use your thumbs to gently pull the upper left and right parts of the front panel in the direction of the arrow.
- ③ When the front panel is fully open, gently lift it in the direction of the arrow.

\*The pre-filter also detaches when the front panel is removed.

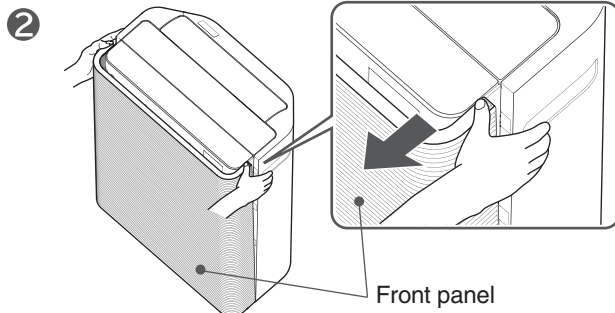

## CAUTION

- Do not forcefully pull the front panel. The unit will fall over and cause injury.

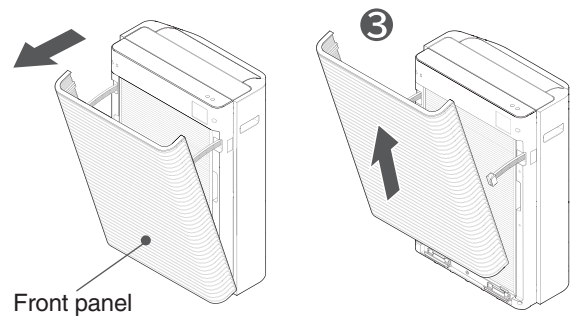

# 2

### Remove the filters

(Dust filter and deodorizing filter)

- ① Remove the dust filter from the unit.
- ② Remove the deodorizing filter from the unit.
- ③ Remove the filters from the Plastic packaging.

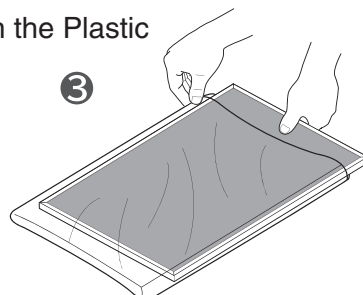

Plastic packaging

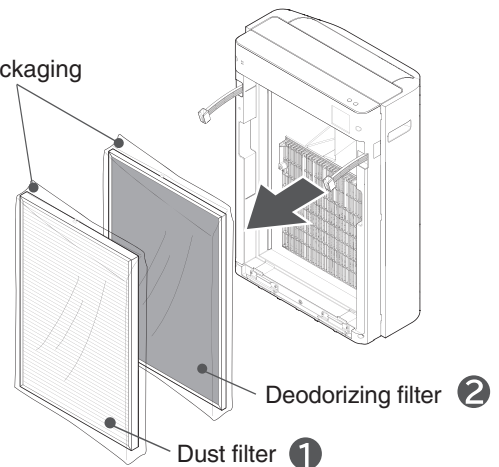

# 3

### Install the deodorizing filter to the unit

- Set the filter on the deodorizing filter setting position.

## CAUTION

- Do not put excessive force and deform the filter.

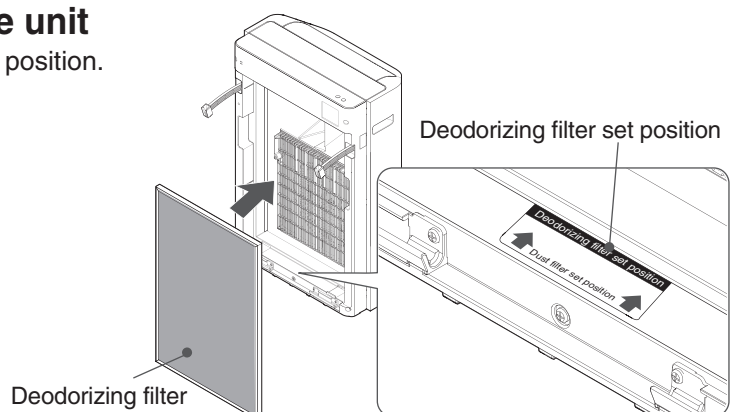

## 4

**Install the dust filter to the unit**

- Set the filter on the dust filter setting position.
- Set the dust filter so that you can see the label "FRONT SIDE"

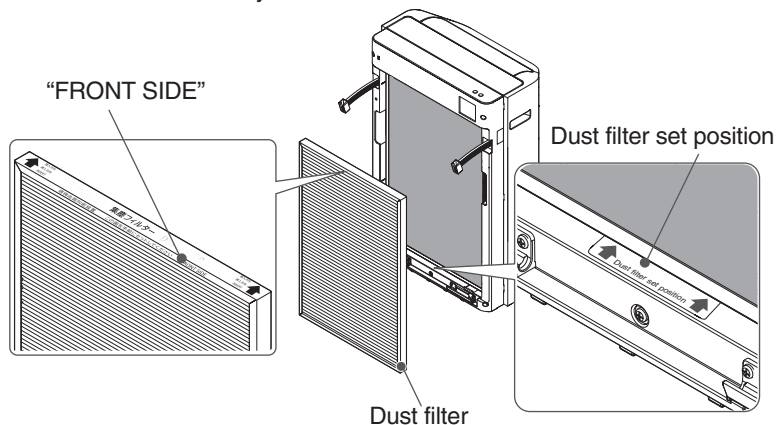

## 5

**Attach the Front panel to the unit**

- 1 Push in the left and right panel arms into the unit.
- 2 Insert the bottom part of the front panel into the panel support.
- 3 Press the front panel until you hear a click to close it.
- 4 Gently pull the upper part of the front panel and check that it does not rattle.

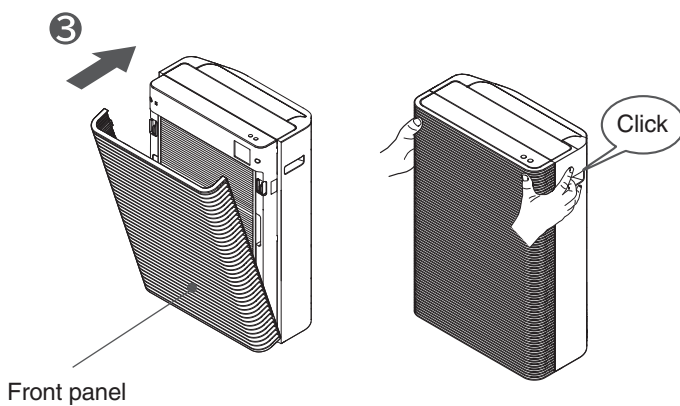
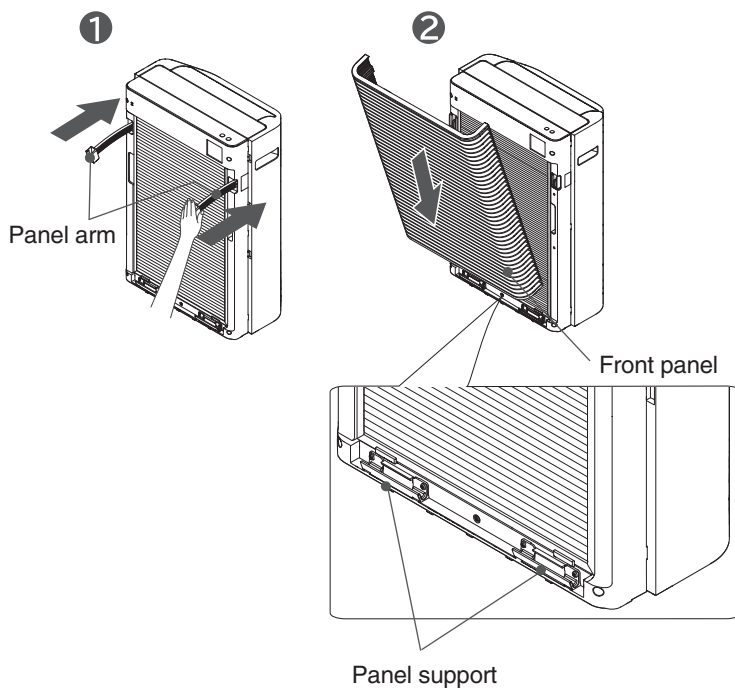

# Installation

- A caster is attached at the base of the unit, thus it should be set on an even, stable and sturdy floor.  
(No stopper attached to the caster)
- Avoid places near heating or cooling equipment and other similar equipment, and choose a location with good air circulation.
- Keep the rear at least 3cm away from the wall. Depending on the operating environment, walls or floors near the outlet may be stained as the unit draws in air. If this is a concern, move it from its current location and clean the surrounding walls and floors regularly.
- Be sure to provide space around the sides of the unit so that the inlets and vents are not blocked by curtains or furniture.

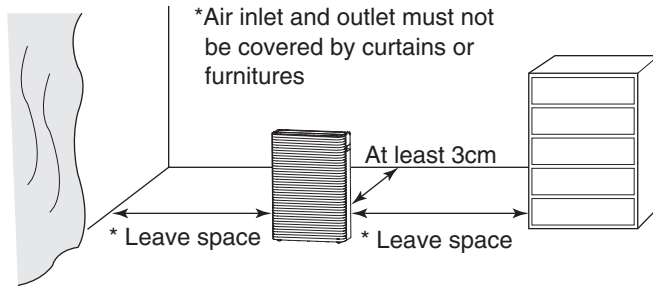

- Be careful not to pull or pinch the power cord.
- Leaving the unit at the same place for an extended period of time may leave stains on the walls and floors. When cleaning the unit, move it to another place and also include cleaning the floor.



## WARNING

- **Do not place on shelves, desks, tables or other similar places**  
Unit may fall due to vibration or tilting, and may cause injury and electric shock.
- **Moving the unit with the caster can be done on a sturdy and even floor. To move the unit on a mat, carpet, or places with uneven surface, carry the unit by its handle.**

# Operation

## Starting Operation

**1** Securely insert the power plug to the outlet

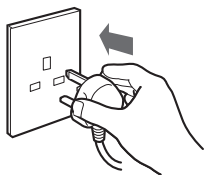

**2** Touch the  power button

Operation will start, and indicator will light up.

Touching the  power button while the unit is operating will dim the indicator and stop the operation of the unit.

- After all indicators have light up at once, “Auto” will light up.
- For the first 3 minutes, the unit will check and store the condition of the room air. During that time, the clean monitor lights up in white. This operation is performed every time you touch the power button to start operation.

Clean monitor

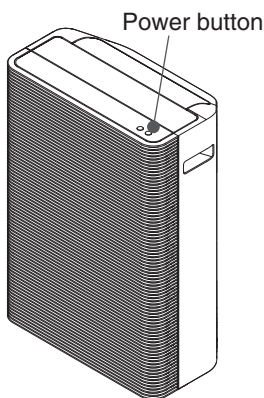
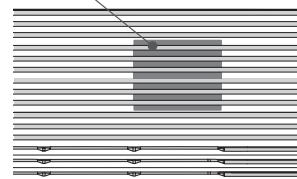

- “Auto” mode is set as a factory default.
- From the second use onward, the memory function enables operation based on the saved status. → (P.E-24)

## Switching Airflow Rate

- Each time the  button is touched while the unit is operating, the airflow rate switches in the following order.

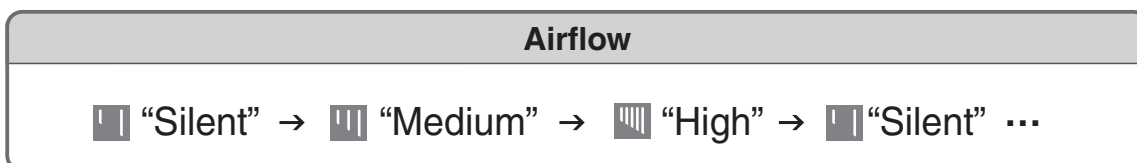

# Operation (Continued)

## Switching Touch Operation Panel Display

- Use this to adjust the unit to your preferred setting.

Touch and hold  
panel display

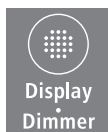

for about 3 seconds and select touch operation









The touch operation panel display will switch at each touch.

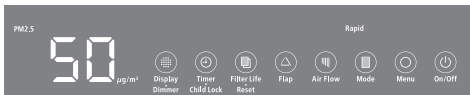

- If the lights in the touch operation panel display are turned off, touch  and operate after the panel is displayed.

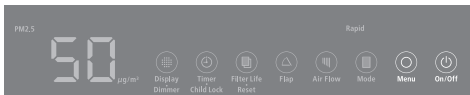
(Touching  again turns off the indicator of the touch operation panel display.)

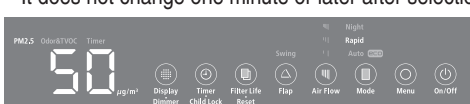
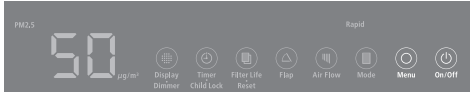
### Display Contents of the Operation Panel

Operation Panel Display	Display Contents			
	When the room is bright		When the room is dark	
	Operation Panel Display /Notification Display	Clean monitor	Operation Panel Display /Notification Display	Clean monitor
Display 1	<p>When selecting the mode or airflow rate, that indicator will light up brightly.</p>  <p>After one minute, it will turn off to save power.</p> 	Light up brightly	<p>When selecting the mode or airflow rate, that indicator will light up dimly.</p>  <p>After one minute, it will turn off to save power.</p> 	Light up dimly
Display 2	<p>The selected mode indicator or airflow rate indicator lights up brightly. Other indicators light up dimly.**</p> <p>* It does not change one minute or later after selection.</p> 	Light up brightly	<p>The selected mode indicator or airflow rate indicator lights up dimly.</p> <p>* It does not change one minute or later after selection.</p> 	Light up dimly
Off	<p>All are off.</p>  <p>* When operating, touch the MENU button to light up the indicator. All of the indicators turn back off one minute after operation.</p>	Off	<p>All are off.</p>  <p>* When operating, touch the MENU button to light up the indicator. All of the indicators turn back off one minute after operation.</p>	Off

- In this instruction manual, the following examples are described in Display 1.

\*\*The display may not be clear to look at when the unit is placed near windows with direct sunlight, and other similarly bright places.

# Useful Features

## Selecting a Mode

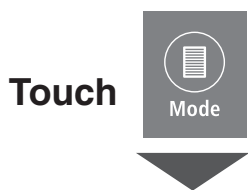

Touch

Each touch changes the operation mode.

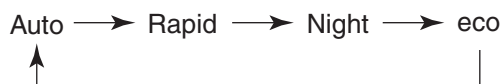

● The indicator of the selected mode will light up.

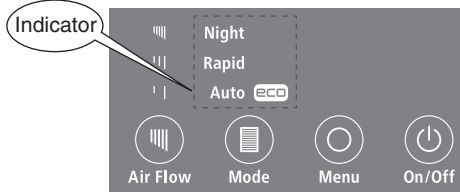

### Auto

- Detects the level of dirtiness in the air with the Odor Sensor and Dust Sensor, and automatically changes the air-flow rate.
- During “Auto” airflow rate operation, the unit operates at airflow rates from Silent to High.  
When the room is dark, the unit operates at a medium or silent airflow rate. → (P.E-25)
- \* The Odor&TVOC monitor value and airflow rate may not operate together.

### Rapid

The unit operates at Max airflow rate.

### Night

When the room is bright, the unit will operate in “Auto” mode.  
When the room is dark, the unit operates at the Silent airflow rate.

### ECO (Eco Saving Operation)

If the air is clean and the “Silent” airflow rate continues for 10 minutes or longer, the fan stops for about 50 minutes and then “Silent” airflow rate operates for about 10 minutes intermittently to save electricity costs.

When the air is clean in auto mode, the unit will continuously operate in “Silent” airflow rate and not stop.

\* During eco saving operation, the level of air contamination is detected by the odor and dust sensors. When the sensors detect odors and dust, the airflow rate will switch depending on the level of air contamination.

When the air is clean and the “Silent” airflow rate operation continues for 10 minutes or longer, the unit will start intermittent operation again.

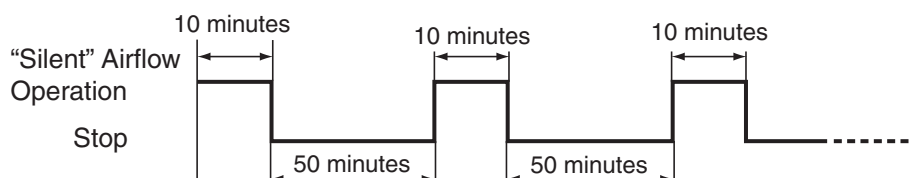

#### Note

- Fan may stop, and monitor display may change depending on the effect of the operation.
- When the fan is stopped during eco operation, you cannot set the flaps to swing.



# Useful Features (Continued)

## Switching Between PM2.5/Odor&TVOC/Timer Monitor Display



- Although the monitor normally displays the amount of PM2.5, you can check the Odor&TVOC level or the remaining time of the set timer.
- The PM2.5 and Odor&TVOC values are guidelines.

Touch  to switch display.

Each touch of the button changes the following monitor display.

PM2.5 (µg/m<sup>3</sup>) → Odor&TVOC → Timer

Display Contents Of Monitor

Monitor Display	Display Contents	Example
PM2.5	Displays the amount of PM2.5 measured by the sensor in units of µg/m <sup>3</sup> . Value : 75 or more ← ..... → 0 Dirtiness Level : Dirty ← ..... → Clean * It does not operate with the clean monitor and automatic operation.	 (when the value is 50 µg/m <sup>3</sup> )
Odor&TVOC	Displays the strength of the odor and TVOC measured by the sensor from 0 to 100. Value : 100 ← ..... → 0 Odor strength : Strong ← ..... → Faint	 (when the value is 80)
Timer	Displays the remaining time of the timer.	

\* The Monitor display switches to PM2.5 automatically one minute after displaying the Odor&TVOC or timer.

## Stopping Operation Using Off-timer

- Set the off-timer to automatically stop the unit after the set operation time.

Touch  to set the timer.

At each touch the following display will appear on the Monitor display for setting.

2h → 4h → 6h → 8h → Off

Display Contents Of Monitor

Monitor Display	Display Contents	Example
Timer	Automatically stops after the set operation time. The indicator lights up while the timer is set.	 (When the off-timer is set to 4hr)

\* The Monitor display switches to PM2.5 automatically one minute after setting the timer.





# Setting the Child Lock

- Prevents accidental operation by children through restricting the operation.
- This can be set while the unit is operating.  
The same process goes for unlocking the unit.



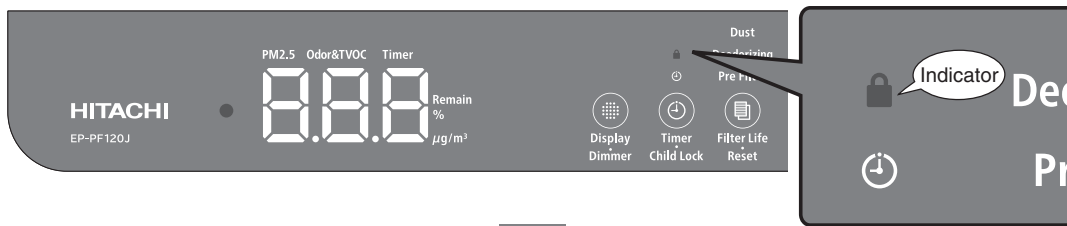

## 1 Touch and hold for about 3 seconds

- After touching and holding  for about 3 seconds, a buzzer will ring once (beep) and the child lock indicator will light up.



- To cancel the child lock, touch and hold  for about 3 seconds. Then the buzzer will ring twice (beep, beep), and the child lock will be canceled.
- Each time  is touched and held for about 3 seconds, the child lock be set or cleared. The indicator will go off when the child lock is canceled.

### Note

- After setting the child lock, no other buttons can be used except , , and child lock operations.
- In the event of a power interruption, restoring the power does not deactivate the child lock setting, even after touching the  power button and after removing the power plug from the outlet. Hold  for 3 seconds and cancel the settings.

# Making the Flap Swing

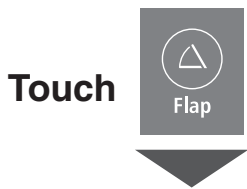

The flap starts swinging.

### Note

- Do not move the automatic flaps with your hands. Doing so may cause them to move incorrectly. If you accidentally move them with your hands and they move incorrectly, stop operation with the power button, wait about 25 seconds, and start operation again.
- This is disabled while the unit is in "child lock".

- The Swing indicator will light up.

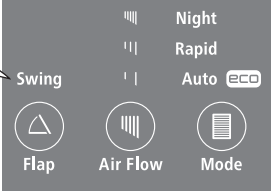

- The setting switches on and off every time you touch the button.

Swing → Off



- When swinging is canceled, the flaps open facing upward.

## CAUTION

- Do not insert your fingers or other long objects into the air outlet. Otherwise, it may cause injury or malfunction.
- Do not touch the automatic flaps while they are swinging. Otherwise, your hands may get caught.

# Useful Features (Continued)



## Displaying the estimated cleaning and replacement periods of each filter

Touch  and select the Filter.

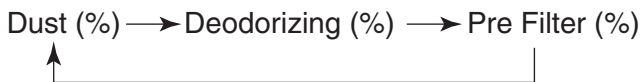
Each touch of the button changes the following filter. When you select a filter, its indicator lights up.



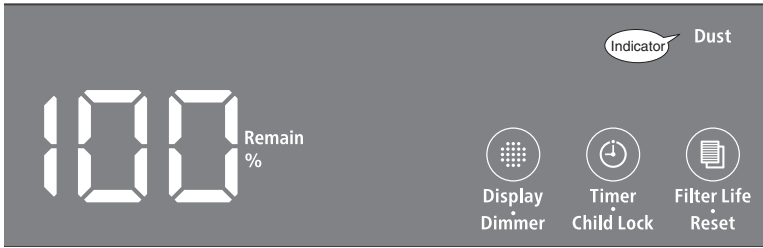
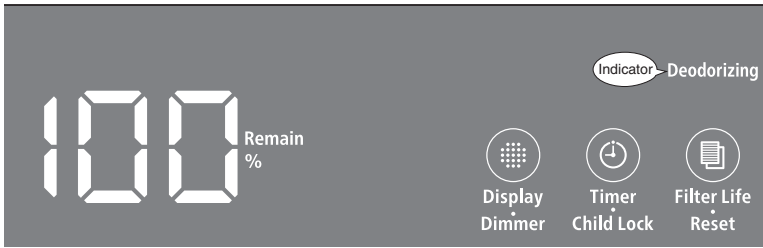

Display Contents Of Monitor

Monitor Display	Display Contents	Example (when the value is 100%)
Dust	Displays the remaining life of the dust filter until replacement as a %.	
Deodorizing	Displays the remaining life of the deodorizing filter until replacement as a %.	
Pre Filter	Displays the remaining life of the pre-filter until cleaning as a %.	

- The display switches to PM2.5 one minute after displaying Dust, Deodorizing, or Pre-Filter.
- The value displayed in the monitor is a guideline.  
Regardless of the dirtiness of the filter, it decreases from 100% to 0% as time passes.  
If air does not come out, odors are strong, or odors remain even before the value reaches 0%, clean (P.E-26, E-27) or replace (P.E-30) the filter. Afterwards, perform the reset operation (P.E-23) to reset the values to 100%.  
When operating continuously at medium airflow rate, replacement of the dust and deodorizing filters is about 10 years, and pre-filter cleaning is about one month.  
At high airflow rate or Rapid operation, the periods are shorter, and at silent airflow rate, the periods are longer.

## If a filter indicator blinks

- The Dust, Deodorizing, and Pre-Filter indicators blink to notify that it is time to replace the dust filter or deodorizing filter, or time to clean the pre-filter.

Display	Action
 <p>Dust Deodorizing Pre Filter</p> <p>Blinks</p>	<p>If the Dust indicator blinks, replace the dust filter by following the “How to Replace the Dust Filter / Deodorizing Filter” procedure. → (P.E-30)</p>
 <p>Dust Deodorizing Pre Filter</p> <p>Blinks</p>	<p>If the Deodorizing indicator blinks, replace the deodorizing filter by following the “How to Replace the Dust Filter / Deodorizing Filter” procedure. → (P.E-30)</p>
 <p>Dust Deodorizing Pre Filter</p> <p>Blinks</p>	<p>If the Pre-Filter indicator blinks, clean by following the “Cleaning” procedure. → (P.E-26)</p>

## Resetting a filter indicator

- After replacing or cleaning a filter, touch the Reset button to reset the filter life or cleaning period. You can perform the reset operation even when the filter indicator is not blinking.

**Select the filter you want to reset → (P.E-22)**

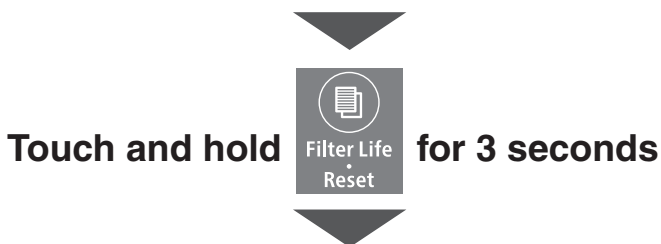

The buzzer beeps once and resets.  
The indicator lights up.

# Memory Function / Monitor / Sensors / Auto Detection

## Memory Function

- When  power button is turned on, the unit operates the previous operation mode set prior to turning off.

## Clean monitor

- The level of air contamination detected by the odor and dust sensors is indicated by different colors.

Display Color : Blue ↔ Green ↔ Yellow ↔ Orange ↔ Red  
Dirtiness Level: Clean ←.....→ Dirty

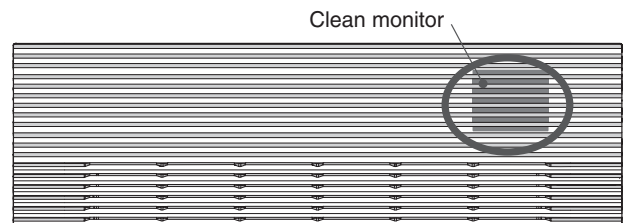

### Note

- When the unit is placed in a location where contamination is difficult to detect, or when the sensor needs cleaning, the display color may not change.

## Odor Sensor

- This sensor detects odors and VOC in the air, such as cigarette smoke and pet odors. Even if you think the air is clean, the unit may continue the operation if the odor sensor detects any gas component that has not been removed by the filter. Also, any of the following may be detected by the odor sensor.
  - Combustion gases from heating appliances during use, alcohol, odor of perfumes or cosmetics used in beauty parlors or aesthetic salons, sprays, vapors, abrupt temperature changes, etc.

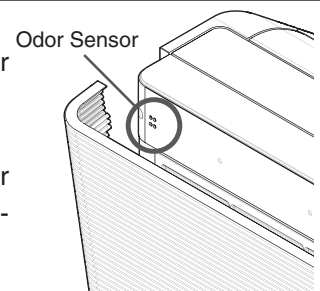

## Dust Sensor

- This sensor detects particulates in the air, such as PM2.5, cigarette smoke, house dust, and pollen. The dust sensor may fail to sense dust stirred up when you lay out or put away bedding, which contains significantly fewer contaminants than cigarette smoke, etc. In such a case, the clean monitor display may appear to be different from the apparent dust in the air.
- The dust sensor may not function properly if the sensor is dirty. Carry out periodical cleaning of the dust sensor and the parts around it.

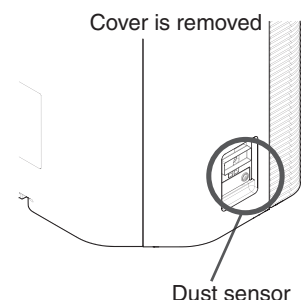

## Auto Detection

- The air purifier performs automatic operation by detecting room air contamination using the “Odor Sensor” and “Dust Sensor”. During the first 3 minutes after the power is turned on, the unit will check the air condition of the room.
- The purifier operates even while it checks the air condition of the room. During this time, the “Clean Monitor” lights up in white.
- After checking the air condition, the “Clean Monitor” will display the room air contamination using the “Odor Sensor” and the “Dust Sensor”.
- If you plug in the power cord in an environment containing contaminated air, the sensitivity of the sensor may be reduced. To clean the air of the room, operate in “High” or “Rapid”. Or open a window and unplug the power cord from the AC outlet when ambient air is clean and plug it back in after 10 seconds.

# Light Sensor



- When the room is dark, the touch operation panel and clean monitor dims automatically. When setting the operation mode, the airflow rate changes as shown in the table below. You can switch the airflow rate manually if you do not want to change it. → (P.E-17)



Operation mode	Airflow rate
Auto	Medium or Silent
Rapid	Rapid operation (Max airflow rate) continues.
Night	Silent
eco	Stays in eco saving operation

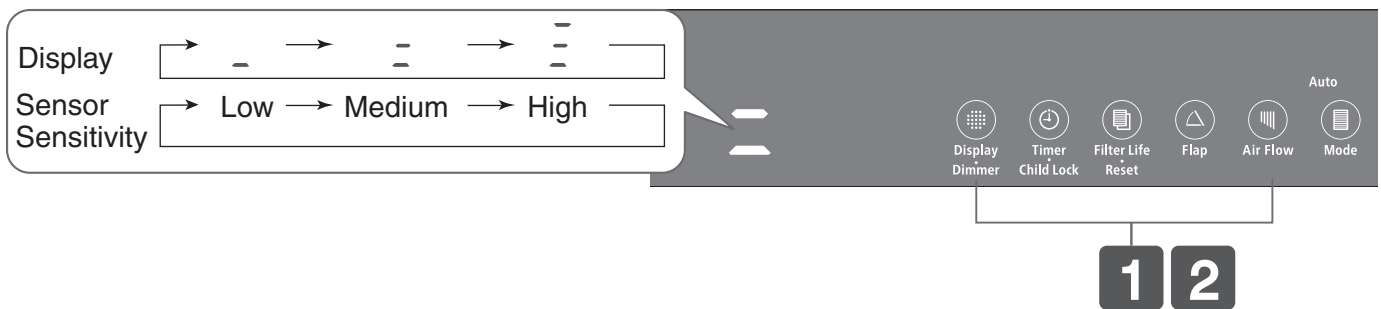

## Adjusting Sensory Sensitivity Setting





- Sensitivity of the “Odor Sensor” and “Dust Sensor” which performs automatic switching of airflow rate can be adjusted in 3-step fashion. You can adjust the sensor sensitivity setting as desired.
- The “Odor Sensor” and “Dust Sensor” are similarly adjusted.
- If the display or airflow rate setting changes during operation, set it again.



- 1** While touching , touch and hold  for about 3 seconds

  - The current sensitivity is indicated and displayed. (Factory setting is )
- 2** While the sensitivity is being displayed (about 10 seconds), continue touching and holding  for about 3 seconds, while touching  once more

  - The sensitivity display will change from  → .
- 3** Furthermore, when switching sensitivity, repeat procedure **2**.

When repeating, the sensitivity display will switch like this  →  →  →  → ...

  - About 10 seconds after the sensitivity display has been switched, it will disappear and the selected sensor sensitivity will be set.

# Cleaning



## WARNING

- Do not stop operation by unplugging the power plug. Otherwise, it may cause fire, electric shock or unit failure.



## CAUTION

- Do not splash water on the unit. Doing so may cause a unit failure.
- Do not use volatile solvents, such as gasoline, thinner, benzene, wax, kerosene, alcohol, etc. or polishing powder, or detergent (used for kitchen or laundry). Such chemicals could cause deformation, discoloration, damage or removal of print labels.
- When using a chemically treated cloth, follow safety instructions.
- Do not use a dryer or heater to dry the unit. Heating could cause deformation, discoloration, damage or removal of print labels.
- Lay a soft cloth or similar material beneath and around the purifier body to protect the floor against scratches and from getting wet.
- Do not tilt or tip over the unit.

## Pre-filter (Cleaning guideline: When the pre-filter indicator flashes, or about once a month)

### 1 Check if the operation has stopped before removing the power plug from the socket

- While operating, touch the  power button and stop operation.

### 2 Open the front panel. → (P.E-14)

### 3 Remove the pre-filter from the front panel.

- The pre-filter is hooked onto the front panel. Hold the upper-center part of the pre-filter and pull in the direction of the arrow to remove it.

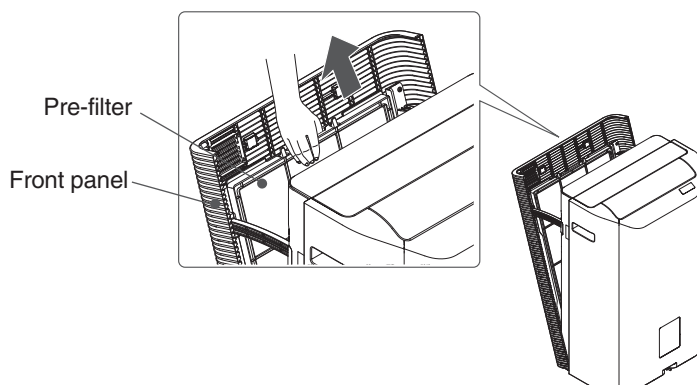

### 4 Cleaning

- Remove dust using a vacuum cleaner.
  - Lightly clean using the nozzle brush of the vacuum cleaner and vacuum the dust.
- Remove dirt by washing with water.
  - If it is extremely dirty, wash it with water and a soft sponge without using excessive force. Drain well and let it dry in a well-ventilated area away from direct sunlight.

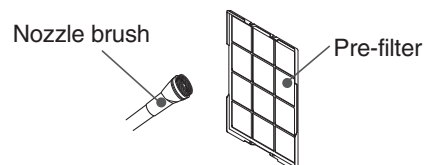

Note: Clean the back face as well.

#### CAUTION

- Do not use detergent (kitchen or laundry use) for cleaning.

## 5 Attach the pre-filter to the unit

- 1 Hold the depressed part of the pre-filter and insert it into the front panel.
- 2 Insert the two hooks of the front panel into the pre-filter insertion slots.

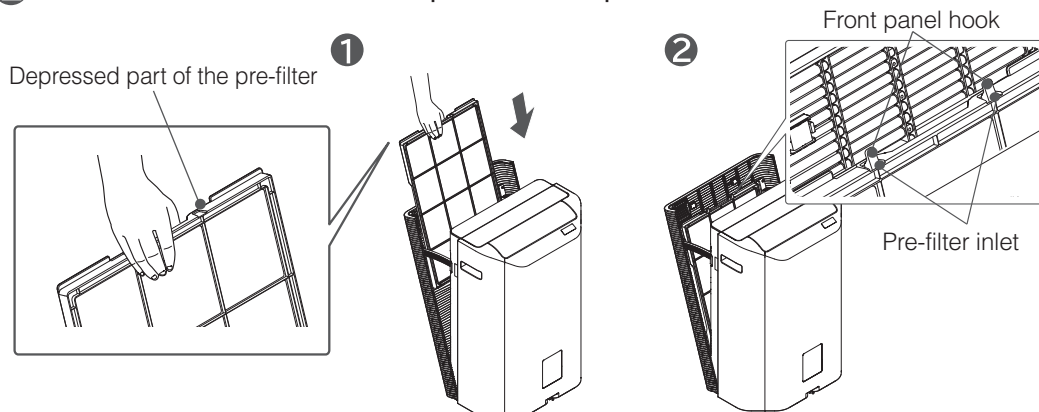

## 6 Close the front panel until you hear a click. → (P.E-15)

- The pre-filter is disposable.

When damaged pre-filter needs to be replaced, please purchase a service part (part no. EP-PF120C 903).  
→ (P.E-34)

## Dust Filter / Deodorizing Filter (Cleaning guideline: About once a month)

### 1 Check if the operation has stopped before removing the power plug from the socket

- While operating, touch the  power button and stop operation.

### 2 Remove the front panel and pre-filter → (P.E-14)

### 3 Cleaning

- The dust on the dust filter or deodorizing filter may emit an odor.  
Be sure to remove the dust using a vacuum cleaner or the like.
  - Lightly clean using the nozzle brush of the vacuum cleaner and vacuum the dust.



**CAUTION**

- The dust filter and deodorizing filter cannot be washed with water.

**CAUTION**

- Do not put excessive force and deform the dust filter.

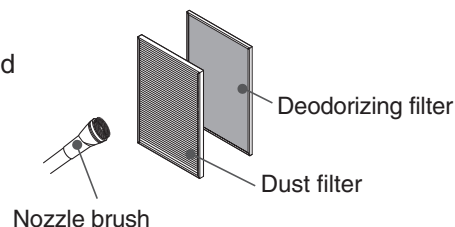

### 4 Attach each filter → (P.E-14, E-15)

### 5 Attach the pre-filter and front panel to the unit → (P.E-15)

**CAUTION**

- The deodorizing filter cannot remove the odor of harmful substances in cigarettes (carbon monoxide, etc.) or continuously occurring odors.
- Use in places with strong smells such as cigarettes or barbecue will shorten the life of the deodorizing filter.  
In such a case, be sure to use the deodorizing filter while ventilating the room.

# Cleaning (Continued)

## Purifier (Guide for Cleaning: About Once a Month)

- Wipe off dirt on the unit, touch operation panel and the surface using a soft, damp cloth.
- Clean adhering chemicals such as oil components and insecticides regularly.
- Remove dust from the surfaces of the front panel air inlet, dust sensor, odor sensor and using a vacuum cleaner and wipe off using a soft cloth.  
Remove the front panel when cleaning the odor sensor. → (P.E-14)
- Do not clean only the front side of the front panel, but detach it from the unit and clean the back side as well.

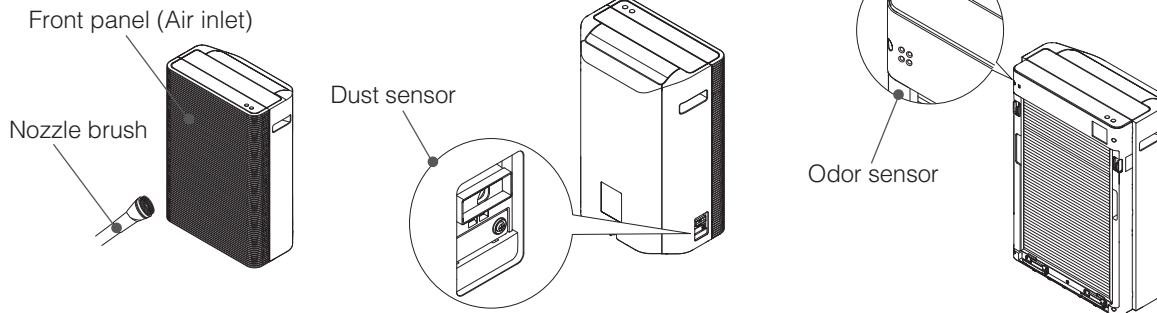
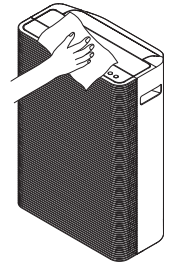

## Dust Sensor (Guide for Cleaning: At Least Once Every 3-6 Months)

- Clean regularly at least once every 3-6 months.  
The dust sensor is less likely to detect dirt in the air if it is not cleaned regularly.  
If the sensor is dirty, it might not work properly and will detect dust even if the air is clean.

### 1 Check if the operation has stopped before removing the power plug from the socket

- While operating, touch the  power button and stop operation.

### 2 Remove dust sensor cover and collect the dust

- Place your finger on the lower part and press.
- Remove the dust cover, vacuum well using the nozzle brush of the vacuum cleaner, and wipe using a soft cloth.

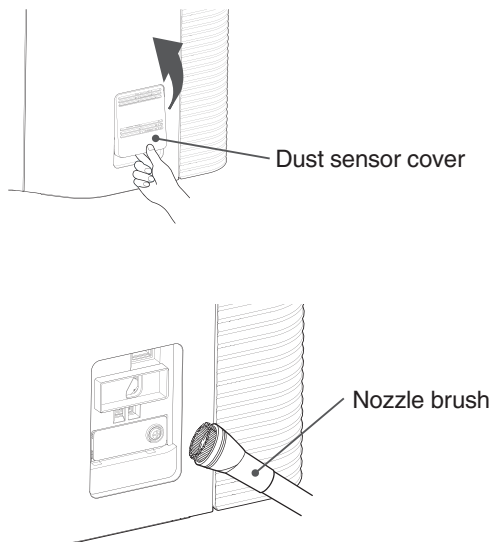

### 3 Wipe the lens with a cotton swab (commercial product)

- When dirt is difficult to remove, wipe the lens with a cotton swab slightly moistened with water, then wipe with a dry cotton swab after.
- Remove all dust around the lens.
- After cleaning, attach the dust sensor cover.
- After cleaning, plug the air purifier in a clean environment and turn on in Auto mode. If the Clean Monitor does not turn blue after about 10 minutes, there might be remaining dust left.  
Please clean it again.

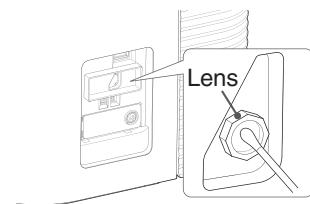

#### CAUTION

- Do not put excessive force on the lens.  
This may cause damage.
- Do not use excessive force when removing and attaching the tabs of the dust sensor cover.  
This may cause damage.



# Replacing the Dust Filter / Deodorizing Filter

## Replacement Interval

---

- **The filter is disposable. The deodorizing performance of the filter decreases with use.**

The standard life of a dust filter and a deodorizing filter is approximately 10 years as determined by the Japan Electrical Manufacturers' Association.

- A test according to JEM1467(Japan Electrical Manufacturers' Association) was conducted. If 5 cigarettes are smoked per day:

[Dust Filter] Number of years is up to the point the air purifying time takes twice as long as when the filter was new.

[Deodorizing Filter] Number of years is up to the point the deodorizing rate (ammonia, acetaldehyde, and acetic acid usually contained in tobacco) becomes half as when the filter was new.

\* This is only a guide. It differs from the actual use in an average household.

- **Replace the deodorizing filter when it becomes difficult to remove odor.**
- **Depending on the location and usage, it may also be shortened. If it becomes difficult to remove dust or odor, replace the filter immediately. Otherwise, the filter may generate odors.**
- **The following cases will shorten the life of the filter:**
  - When the purifier takes in oily smoke, carbon substances (soot), etc. or when the smell of new building materials remains after the construction or remodeling of a building
  - When used in stores, such as in coffee shops, game parlors, barber shops, beauty parlors, hotels, inns, and offices
  - When used in places with strong smells such as cigarettes, barbecue, aroma oils, or air fresheners
  - When the purifier takes in combustion gases generated by heating appliances
  - When the purifier takes in solvents such as paints, adhesives, etc.
  - When used in dusty locations near roads subject to heavy traffic.

# Replacing the Dust Filter / Deodorizing Filter (Continued)

## How to Replace the Dust Filter / Deodorizing Filter

**1** Check if the operation and the fan have stopped, and then unplug the power cord

- While operating, touch the  power button and stop operation.

**2** Remove the front panel and pre-filter → (P.E-14)

**3** Remove the old filters → (P.E-14)

- Remove the dust filter first, then the deodorizing filter.

**CAUTION**

- Do not put excessive force and deform the dust filter.

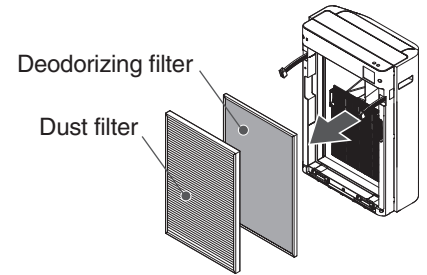

**4** Remove the plastic packaging of the new filter, and attach the filter in the unit

- ① Remove the plastic packaging of the new filter.

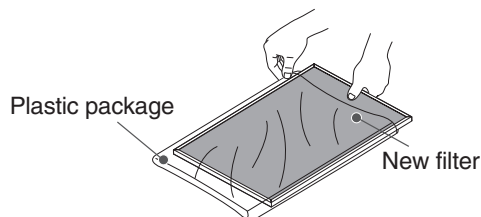

**CAUTION**

- Use only a genuine filter for the Hitachi Air Purifier. Other filters may cause unit to malfunction.

- ② Attach the deodorizing filter to the unit.

- ③ Attach the dust filter to the unit.

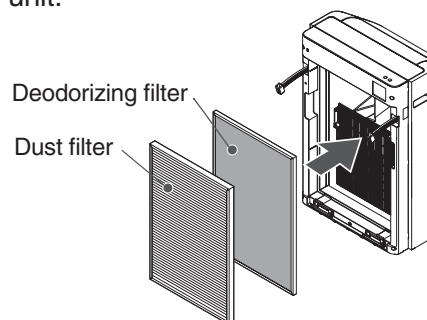

**CAUTION**

- If the filter is set while without removing its plastic packaging, it will not be able to have a cleaning effect. It will also cause unit malfunction.
- The vibration during transporting the unit might cause deodorizing agent granules to fall out from the filter.
  - When removing the plastic packaging of the filter and attaching the filter to the unit, make sure that your hands, clothes, and the surroundings does not get dirty.
  - Wipe off any granules that may have fallen or clung to the filter.
  - This will not affect the deodorizing performance.

**5** Attach the pre-filter and front panel to the unit → (P.E-15)

# Troubleshooting Guide

## When a notification is displayed on the monitor

Notification Display and Details	Solution
 <p>Fan is not rotating.</p>	<p>Pull out the power plug and then insert it again before operating. If the same message appears, discontinue use, make sure to unplug it from the outlet, and request repairs.</p>

## Before Requesting Repairs

Symptoms	Check	Solution
Air does not come out or it will not turn on	● Is the power plug properly inserted in the outlet?	Insert the power plug properly in the outlet.
	● Is the breaker switched off?	Switch on breaker.
	● Did you turn on the “Power” button on the unit?	Touch the “Power” button to turn on.
	● Are the dust filter and deodorizing filter correctly installed in the unit?	Install filters correctly in the unit. → (P.E-14, E-15)
It cannot be operated	● Is the child lock set?	Cancel the setting. → (P.E-21)
	● Are there any water droplets or dust on the operation panel?	Wipe off with a soft cloth. → (P.E-6, E-7)
	● Are you wearing any gloves or have bandages?	Touch it directly.
	● Are you touching any other buttons?	Touch one at a time.
The operation stopped midway	● Is it operating in “Eco Saving Operation” mode?	Switch to other mode. → (P.E-19)
The airflow rate does not decrease even though the air is clean	● Is the airflow rate switched?	Select Auto mode or another airflow rate. → (P.E-17, E-19)
The airflow rate does not increase even though the air is contaminated	● Is the airflow rate switched?	Select Auto mode or another airflow rate. → (P.E-17, E-19)
	● Is the odor sensor opening blocked by dust or any other objects?	Clean the odor sensor. → (P.E-28)
	● Is the dust sensor dirty?	Clean the dust sensor. → (P.E-28)
	● When the power plug is in the outlet, did the air around become clean?	Switch the airflow rate. → (P.E-17) Or open a window, unplug the power plug from the outlet when the surrounding air becomes clean, and plug it in again after 10 seconds. → (P.E-24)

# Troubleshooting Guide (Continued)

Symptoms	Check	Solution
The clean monitor display color does not change from blue	● Is the unit placed in a location where it cannot be reached by odors and dust?	Try moving it to another location.
	● Is the dust sensor dirty?	Clean the dust sensor. → (P.E-28)
	● Is the odor sensor opening blocked by dust or any other objects?	Clean the odor sensor. → (P.E-28)
The clean monitor display color does not change from red	● Is there anything nearby that the odor sensor may detect? <ul style="list-style-type: none"> <li>● Heating appliances that generate combustion gases</li> <li>● Alcohol, cosmetics, sprays, etc.</li> </ul>	The purifier may detect components of invisible gas that cannot be cleaned by the filter and still continue operating. Open a window for ventilation. → (P.E-24)
	● Is the dust sensor dirty?	Clean the dust sensor. → (P.E-28)
	● Is the odor sensor opening blocked by dust or any other objects?	Clean the odor sensor. → (P.E-28)
The filter indicator continues flashing	● Did you reset the filter indicator after cleaning or replacing the filter?	When you select the filter you want to reset and touch and hold the reset button for 3 seconds, the indicator returns to lit up. → (P.E-23)
The touch operation panel display disappeared	● Did you set the touch operation panel display to be hidden?	Hold the display switch button for 3 seconds and switch the display settings. → (P.E-18)
It is hard to remove the smell or the unit has a smell	● Is the pre-filter too dirty?	Refer to “Pre-filter” in “Cleaning” when cleaning the pre-filter. → (P.E-26)
	● Is the filter dirty? Or is it time to replace the filter?	Refer to “Replacing the Dust Filter / Deodorizing Filter” when replacing the filter. Depending on the location or usage, the replacement interval may be shorter, even before the filter indicators start blinking. → (P.E-29)
The airflow rate switched in the middle of operation	● Is it set in “Auto” airflow rate, or “Eco Saving Operation”?	Switch airflow rate or select other mode. → (P.E-17,E-19)
	● Are the front panel and filters correctly set?	Set them correctly.

# Following Conditions are Normal

## Sounds and Vibrations

Symptoms	Cause (This is normal)
The flap makes whirring, rattling, and rumbling noises when it is opened, closed, or in swing mode	It is the sound of the motor that moves the flap.
The unit vibrates when it is on "Rapid" mode	It is because of the rotation of the fan.
When switching the operation mode or air-flow rate, the purifier sometimes makes whirring and whirling sounds	This is the sound of the unit changing the rotational speed of the motor.

## Heat and Smells

Symptoms	Cause (This is normal)
The air coming out of the air outlet smells	The unit's parts have a smell when it is first used. Or the deodorizing performance of the deodorizing filter has decreased. Clean the deodorizing filter. → (P.E-27)
The Touch Operation Panel is warm	The unit's interior is lined with control circuits. This causes the unit to become warm.

## Operations / Others

Symptoms	Cause (This is normal)
The movement of the flap is unstable, or its direction is misaligned	It may have become misaligned when it was moved by hand. If it does not work properly because it was moved by hand, stop it by touching the "Power" button once, and start the operation again.
The fan stopped	The fan may stop if it is set in eco saving operation. → (P.E-19)
The rotation does not increase smoothly when "Rapid" mode is used	The rotation gradually increases. It takes approximately 1 minute for the rotation to increase.
Noise enters the television and radio	Separate the purifier from the television and radio, or change the orientation of the purifier. Or, use an outlet in a different location.

# Replacement Parts

Purchase from Hitachi Home Appliances dealers.

- **Dust filter for Hitachi Air Purifier (Allergen-free, HEPA filter)**  
Specify service part EP-PF120C-901

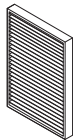

- **Deodorizing filter for Hitachi Air Purifier**  
Specify service part EP-PF120C-902



- **Pre-filter**  
Specify service part EP-PF120C-903



# Specifications

Model	EP-PF120J			
Power Supply	AC 220-240V 50-60Hz			
Applicable Floor Space	84m <sup>2</sup>			
	Max	High	Medium	Silent
Airflow Rate (m <sup>3</sup> /min.)	12.0	4.0	3.0	1.0
Power Consumption (W)	75	11	9	6
Unit Dimensions	657mm (H) × 450mm (W) × 280mm (D)			
Weight	Approx. 11.5kg			
Power Cord Length	Approx. 1.8m			

Model	EP-PF90J			
Power Supply	AC 220-240V 50-60Hz			
Applicable Floor Space	65m <sup>2</sup>			
	Max	High	Medium	Silent
Airflow Rate (m <sup>3</sup> /min.)	9.0	4.0	3.0	1.0
Power Consumption (W)	43	11	9	6
Unit Dimensions	657mm (H) × 450mm (W) × 280mm (D)			
Weight	Approx. 11.5kg			
Power Cord Length	Approx. 1.8m			

